

FAX NO. :12317432173

FROM :

176.07'

P.O.B.

14 MILE ROAD - COUNTY PUBLIC - 86.00' R.O.W.

REFLAT OF THE EAST ONE HALF OF MIDDLE BRANCH CEMETERY PART II (KNOWN AS CEMETERY II, PART II)

53.00' R.O.W.

33.00' R.O.W.

30.43'

118.00'

MIDDLE BRANCH CEMETERY MIDDLE BRANCH TOWNSHIP OSCOLA COUNTY MICHIGAN 49665

GRAVE SITES BURNISHED AS FOLLOWS...

ROW 1 6' 222

ROW 2 6' 220

ROW 3 6' 219

ROW 4 12' 204

ROW 5 6' 203

ROW 6 6' 184

ROW 7 12' 183

ROW 8 14' 164

ROW 9 16' 163

ROW 10 6' 144

ROW 11 6' 143

ROW 12 12' 124

ROW 13 12' 123

ROW 14 18' 104

ROW 15 6' 103

ROW 16 6' 84

VAULT BLDG

ALLEY

ALLEY

ALLEY

ALLEY

ALLEY

ROAD

BRANCH

201.02'

27.0'

114.00'

37.11'

N90°00'00"E 172.71'

21.0'

21.0'

B3

DRIVEWAY

41

61

62

283



20M

FAX NO. :12317432173

Jun. 01 2006 03:53PM PC

14 Mile Road

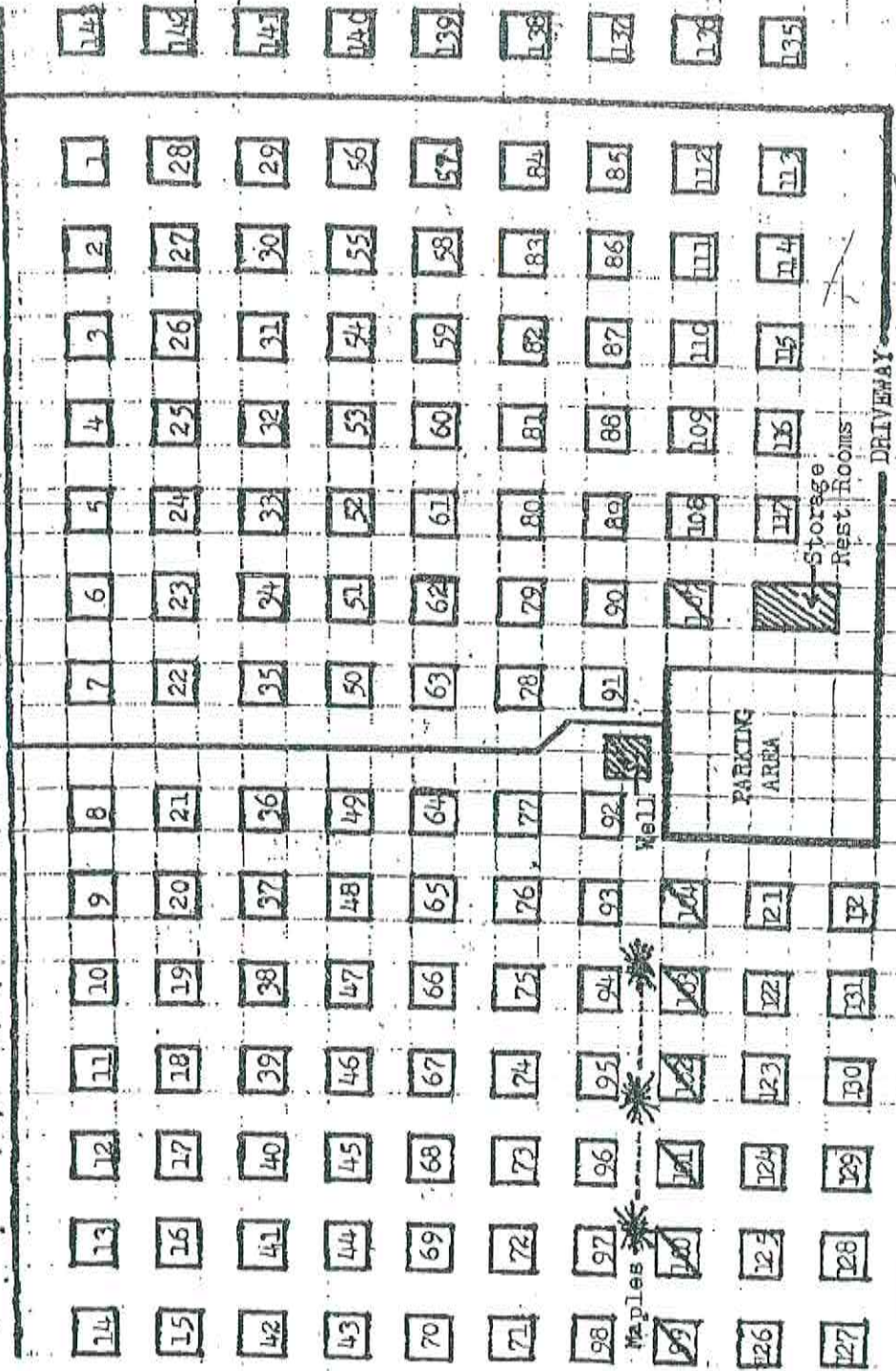

South Fence Line

East Fence Line

MIDDLE BRANCH TOWNSHIP CEMETERY

14 Mile Road Marlon, MI

4 Sites per Plot

Sites Numbered As Follows...

- 4
- 3
- 2
- 1

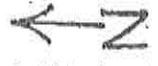

(Map Not Drawn To Scale... For Plot Location Only)

Ree Ford

4063

Att: Andy

14 Mile Road

CEMETERY II, PART I

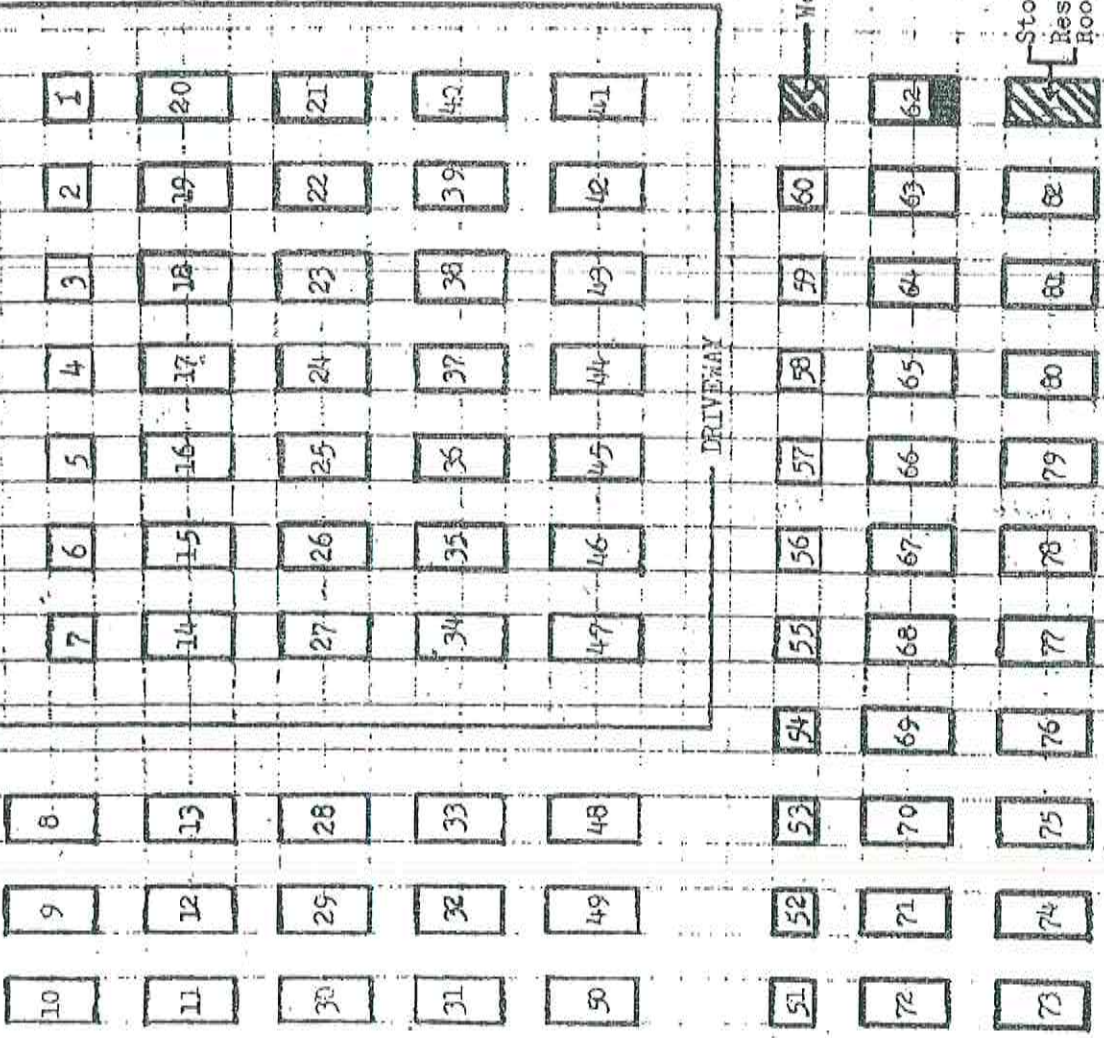

South Fence Line

West Fence Line

MIDDLE BRANCH TOWNSHIP CEMETERY

14 Mile Road

Marion, NJ

- — 3 Sites per Plot
 - — 6 Sites per Plot
- Sites Numbered As Follows... 3
2
1
- Sites Numbered As Follows... 6
5
4
3
2

(Map not drawn to scale... for plot location only)

3083